

*Summer Wedding Guide*



# ELEVATED ELEGANCE

EVENT LOCATION IN AN EXTRAORDINARY  
MOUNTAIN SETTING







## *Location*

Located at 9,095 feet, Rendezvous Peak is accessed via a 10-15 minute ride on the Bridger Gondola and offers dramatic views of Rendezvous Peak and Jackson Hole valley.

**Summer Season: Early June – Early October**







*Occupancy*

The maximum occupancy for Rendezvous Lodge is **400 people**. The average wedding size for this venue is 100-200 people.





ELEVATED ELEGANCE | JACKSON HOLE

PHOTO BY JAMIE CHRISMAN

## Banquet Room

With removable walls and two floors, Rendezvous Lodge is customizable to your party's size.

## Floor Plan

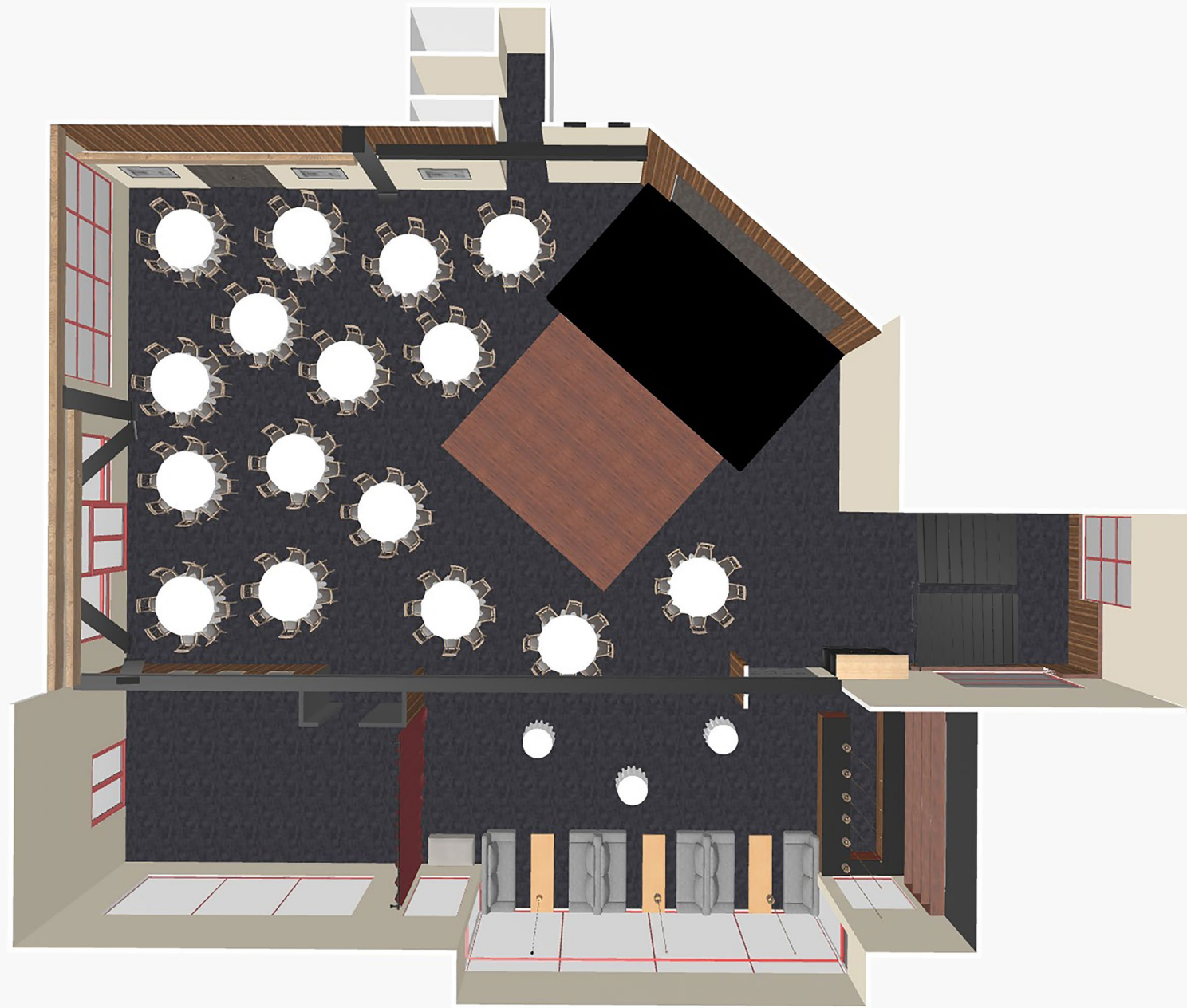





## Menus

- We provide a variety of delicious options for your special day, including cakes and specialty cocktails
- Food is charged per person and drinks are charged based on consumption

**Contact the groups department for menus at [groups@jacksonhole.com](mailto:groups@jacksonhole.com).**





## Logistics

- Rendezvous Lodge events conclude at 10pm with the option to extend to 11pm for an additional \$1500
- No events past 11pm
- The Bridger Gondola is open to the public from 9am-5pm every day and will be running during those times.
- Setup for the ceremony may start at 430pm.

## Outdoor Patios

**Rendezvous Lodge has 2 outdoor patios to use for ceremony, reception, rehearsal or cocktail hour.**

- Buyouts will have use of both patios.
- All activities will be held inside if weather becomes an issue.





## Buyout Cost

**A buyout of Rendezvous Lodge requires a \$21,000 food and beverage minimum\* as well as a \$9,000 facilities fee.**

\*Additional 20% service charge and 6% tax.  
Additional fees for added production, extended set-up time, storage, vehicles, satellite bars and more

## Facilities Fee

**Included:**

- Use of Bridger Gondola and associated operation
- Audio system
- Furniture and kitchenware
- Dance floor
- Deck for ceremony and/or cocktail hour
- Base Parking



**FULL-SERVICE WEDDING AND EVENT PLANNING**

**Contact the groups department for menus at [groups@jacksonhole.com](mailto:groups@jacksonhole.com) or 307.732.3136.**





PHOTO BY JANYE CHRISMAN