



VENUES

AT







THE
NATURAL
CHOICE
FOR YOUR
WEDDING



The Anne Springs Close Greenway is a 2,100-acre nature preserve, providing a beautiful setting for your special event. Whether you are looking to host a grand affair at the Founders Dairy Barn, a laidback fête on the Domtar Forest Porch, or take advantage of our gorgeous greenspace and sister properties, we have several venue options to fit your particular needs.

Venues@ASCGreenway.org
803.547.1009





THE FOUNDERS DAIRY BARN



Built in 1947, the Founders Dairy Barn is an iconic and inviting venue, perfect for both indoor and outdoor events. The expansive loft area features original hardwood flooring and rafters, while the lower level offers a wood paneled assembly space and milk parlor, lined with windows to allow natural lighting during the day and a soft glow for evening activities. A spacious bridal suite and comfortable groom's room make getting ready a relaxing experience for any wedding party. The large outdoor patio, surrounded by pastoral landscape and ample greenspace, accommodates additional seating, tenting and décor providing a perfect backdrop for your special day.

Ideal for weddings, corporate gatherings, receptions, family reunions or any large gathering.





PRICING

Mon-Thurs	\$2,000 - \$3,000
Fri-Sun	\$4,500 - \$5,500

Prices may be higher in peak season
(April-June and Sept-Nov).

CAPACITY

Downstairs	200 Seated
Including Outside Patio	300 Seated
Upstairs Loft (Theater Style)	300 Seated

- Venue host on site for duration of your rental.
- Fully heated and cooled venue.
- Market lights included in cocktail space and permanent drum lighting in reception space.
- Newly custom-built bar for beverage service.
- Ten+ restrooms inside.
- Downstairs - large wedding suite with three angle mirror and seating space, counter space, and mini fridge.
- Upstairs - small wedding suite with full length mirror, seating area, and mini fridge.
- Lift elevator to upstairs loft, catering kitchen and assembly space market lights included.
- Tables, chairs, linens, tenting and additional lighting not included in price. All rentals available through Creative Solutions only.
- Bar packages must be ordered through the Greenway; no outside alcohol allowed.
- Recommended utilization of Preferred Vendor List for caterers and DJ's. Vendors not on list will require a vetting fee and proof of insurance.
- All other vendors may be client's choice.
- 5-hour access times available Monday-Thursday.
- 10-hour access times available Monday-Sunday.

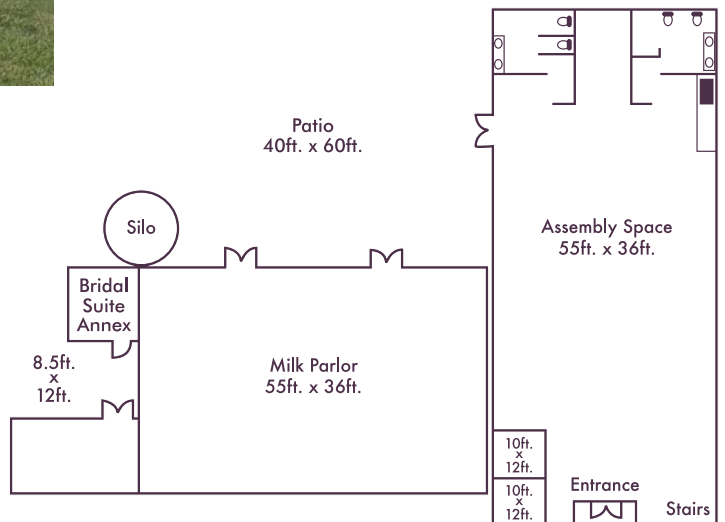



BOB REID FIELD TRIAL BARN



The Bob Reid Field Trial Barn harkens back to the days of field trial competitions, testing the skills of hunting dogs. Today, set atop a rolling crest of pastoral landscape, the Field Trial Barn serves as a laid back, gorgeous venue for events of all kinds. Large sliding barn doors make this venue ideal for a breezy spring or crisp fall event. The rustic wooden interior sets a fun backdrop for events large and small, with a formal outdoor patio space decorated with market lighting and fire pit with built-in seating.

Ideal for weddings, corporate gatherings, receptions, family reunions or any large gathering.





PRICING

Mon-Thurs \$800 - \$1,300

Fri-Sun \$1,500 - \$2,300

Prices may be higher in peak season
(April-June and Sept-Nov).

CAPACITY

Inside Up to 100 Seated

Patio 100 Seated

Inside + Patio 200 Standing

- Venue host on site for duration of your rental.
- Complimentary access to fire pit, indoor potbelly stove, and use of ceiling fans.
- Market lights on the interior and exterior of Field Trial Barn included.
- Newly custom-built rustic bar for beverage services.
- Three restrooms on site, including large family restroom.
- Newly renovated wedding suite with heat/air conditioning, full length mirror, counter desk and dress hooks.
- Tables, chairs, linens, tenting and additional lighting not included in price. All rentals available through Creative Solutions only.
- Wifi available at no additional charge.
- Bar packages must be ordered through the Greenway; no outside alcohol allowed.
- Caterer and DJ may be client's choice. Certificate of Insurance required.
- All other vendors may be client's choice.
- 5-hour access times available Monday-Thursday.
- 10- hour access times available Monday-Sunday.

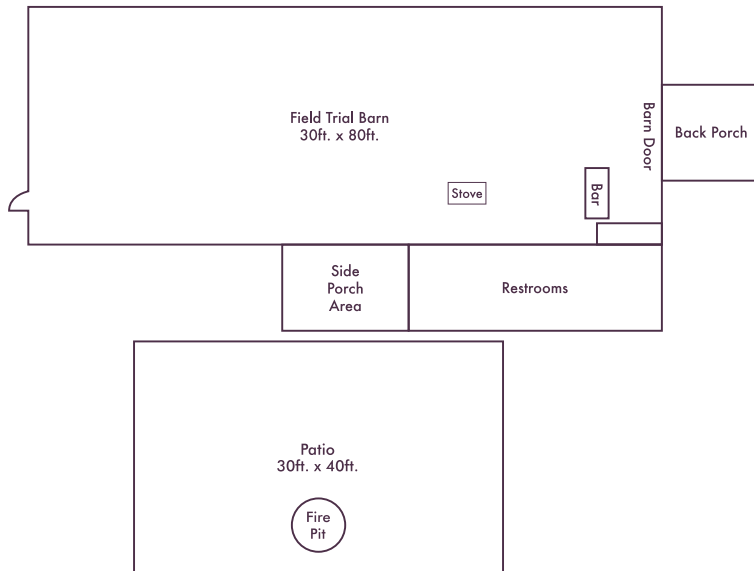

BRUCE T. RUSH PAVILION



The Bruce T. Rush Pavilion is a versatile venue located a short distance from the Greenway Gateway. Secluded among a strand of mature hardwoods, the open-air structure features a beautiful hardwood ceiling and stone fireplace with views of Lake Haigler. Picnic tables are available for seating or utilize rentals to expand seating and covered event space options.

Ideal for birthday parties, corporate gatherings, reunions, social events, celebrations of life, showers and more.





PRICING

5 Hours	\$800
10 Hours	\$1,300

CAPACITY

150 Standing / 100 Seated

- Venue Host on site for the duration of your rental.
- Large stone fireplace with firewood available for purchase through the Greenway.
- Eight picnic tables included in venue rental.
- Restrooms located just across the trail path.
- Bar packages must be ordered through the Greenway; no outside alcohol allowed.
- Caterer and DJ may be client's choice. Certificate of Insurance required.
- Tenting, lightning and other rentals available through Creative Solutions only.
- All other vendors may be client's choice.
- 5- hour access times available Monday-Sunday.
- 10-hour access times available Monday-Sunday.



THE COMPORIUM AMPHITHEATER



Nestled beneath a beautiful tree canopy and set among rolling pastures, the Comporium Amphitheater is located just a short walk from the Founders Dairy Barn. Constructed of amber-hued Douglas Fir timbers with natural Tennessee fieldstone making up the foundation façade, patio and walls, this artfully designed, outdoor venue hosts a variety of events each year. The Amphitheater features a 1,200-square foot stage, complete with theatrical lighting and adjacent storage. The tiered terrain and large lawn allow for ample seating and set up.

Ideal for weddings, corporate gatherings, receptions, family reunions, dance recitals, celebrations of life, church services or any large gathering.





PRICING

Mon-Thurs (5 Hours)	\$800
Mon-Thurs (10 Hours)	\$1,300
Fri-Sun	\$1,800-\$2,200

CAPACITY

Full Venue	1,500
Amphitheater	150 Seated
Activities Lawn	300 Seated

- Venue host on site for duration of your rental.
- Gorgeous stage with lighting, steps and ADA accessible ramp.
- Private room behind stage doors.
- Beautiful overlook of horse pastures and green space.
- Restrooms located a short walk away along a paved path.
- Bar packages must be ordered through the Greenway; no outside alcohol allowed.
- Caterer and DJ may be client's choice. Certificate of Insurance required.
- Tables, chairs, linens, tenting, additional lighting, are not included in this price, all rentals available through Creative Solutions only.
- All other vendors may be client's choice.
- 5-hour access times available Monday-Sunday
- 10- hour access times available Monday-Sunday.

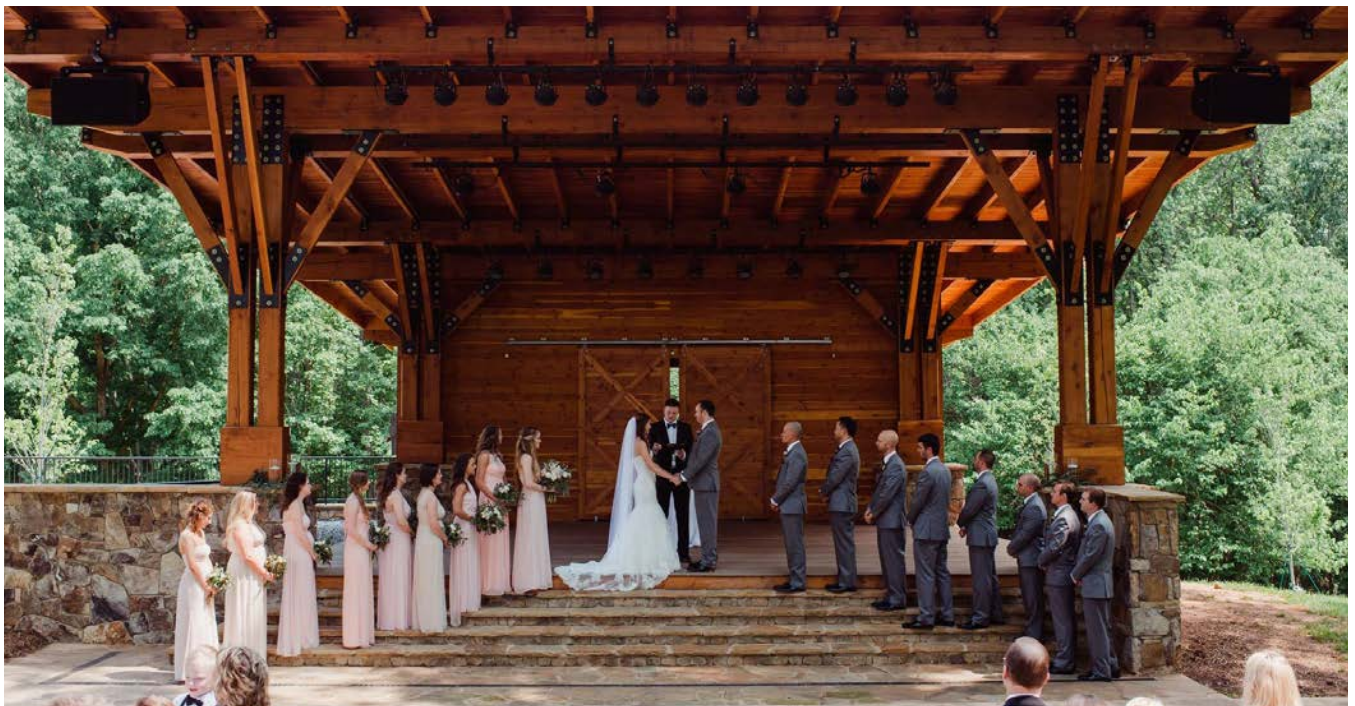



DOMTAR FOREST PORCH



Adjacent to the Greenway Gateway, the Domtar Forest Porch serves as a gorgeous outdoor site for events nestled in nature. Surrounded by mature hardwoods, the spacious outdoor patio provides a beautifully organic yet modern backdrop with multiple side porches to allow your group to spread out. For any occasion, the Domtar Forest Porch stands as a breathtaking, sophisticated space for fellowship.

Ideal for rehearsal dinners, birthday parties, corporate gatherings, showers, social events and other intimate gatherings.



- Venue Host on site for duration of your rental.
- Features a main patio space as well as three decks.
- Ability to rent individual decks.
- Close to Gateway restrooms.
- Patio tables are included in your venue rental.
- Market lights over main porch space included
- Wifi available at no additional charge.
- Bar packages must be ordered through the Greenway; no outside alcohol allowed.
- Catering packages available exclusively through Greenway catering.
- Tenting, lighting, and other rentals available through Creative Solutions only.
- All other vendors may be client's choice.
- 5-hour access times available Monday-Sunday.
- 10-hour access times available Monday-Sunday.

PRICING

Pricing based on date and number of porches rented. All porch rentals subject to food and beverage minimum.

Mon-Thurs, 5 Hours	\$100-\$500
Mon-Thurs, 10 Hours	\$200-\$850
Fri & Sun	\$100-\$1,300
Saturday	\$150-\$1,500

CAPACITY

Each Individual Porch	20-30 Seated
Main Gravel Area	100 Seated
Total Porch	175 Seated





GREENWAY GATEWAY

LAWN



The Greenway Gateway Lawn serves as a gorgeous setting for timeless events. From receptions and parties to picnics and retreats, the manicured lawn with elegant natural landscaping makes a perfect setting for any gathering. Adjacent to the Greenway Gateway and the historic Nation Ford Trail, the spacious lawn provides a beautifully organic, yet modern, backdrop for any occasion providing a breathtaking, sophisticated space for fellowship and celebration.

Ideal for rehearsal dinners, birthday parties, corporate gatherings, showers, or social events.



- Venue host on site for duration of your rental
- Market lights around perimeter of lawn included
- Close access to Gateway restrooms
- Wifi available at no additional charge.
- Catering packages and all food must be ordered through Greenway Catering
- Bar packages must be ordered through the Greenway; no outside alcohol allowed
- All other vendors may be client's choice.
- Tenting, lighting and other rentals available through Creative Solutions only.
- 5-hour access times available Monday-Sunday.
- 10-hour access times available Monday-Sunday.

PRICING

Please complete the [Venues Request Form](#) for information about pricing.

CAPACITY

Lawn (can be tented) 200



THE GIBSON HOUSE



The Gibson House Lawn, located at the Greenway Stables entrance, serves as a gorgeous, outdoor site for timeless events. Overlooking the pond and adjacent pastures, Gibson House activities center around a stone fire pit while horses play in the distance. The enchanting environment is perfect for any outdoor gathering.

Ideal for wedding ceremonies, celebrations of life, social events, picnics and other intimate gatherings.





PRICING

5 Hours	\$500
10 Hours	\$800

CAPACITY

150 standing / 100 seated

- Venue host on site for duration of your rental.
- Beautiful overlook of horse pasture.
- Three air-conditioned restrooms located on site.
- Wifi available at no additional charge.
- Bar packages must be ordered through the Greenway; no outside alcohol allowed.
- Caterer and DJ may be client's choice. Certificate of Insurance required
- Tables, chairs, linens, tenting, additional lighting not included in price. All rentals available through Creative Solutions only.
- All other vendors may be client's choice.
- 5-hour access times available Monday-Thursday.
- 10- hour access times available Monday-Sunday.

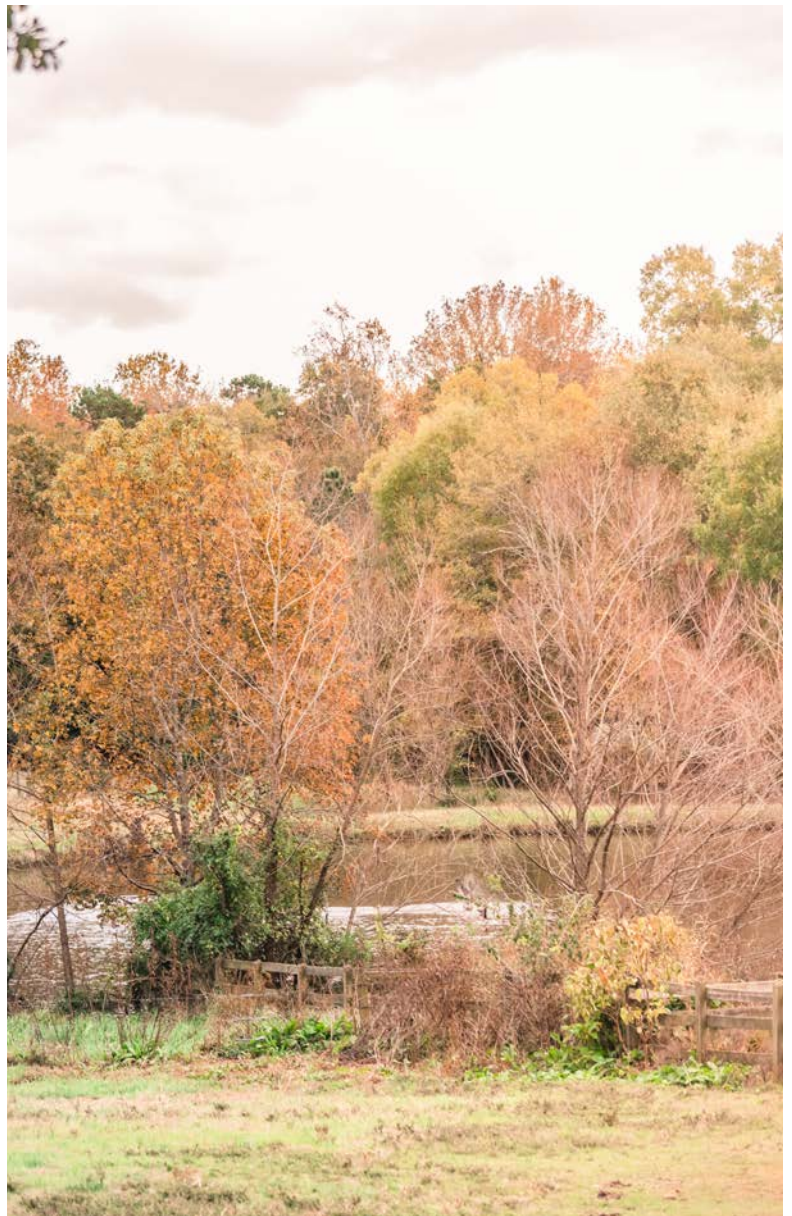

THE HISTORIC GRAHAM CABIN LAWN



Intimately nestled amid a hardwood forest and just a short walk from the Founders Dairy Barn lies the Historic Graham Cabin. Built circa 1780 and occupied continuously for over 200 years before relocating to the Greenway, the cabin and the surrounding lawn take visitors back to a quieter, simpler time. The Historic Graham Cabin Lawn is the perfect place to get close to nature and the rich history at the Greenway.

Ideal for wedding ceremonies, corporate gatherings, celebrations of life, social events, picnics and other intimate gatherings.





PRICING

5 Hours	\$500
10 Hours	\$800

CAPACITY

150 standing / 100 seated

- Venue host on site for duration of your rental.
- Access to wrap around porch and fire pit area. No access to interior of cabin.
- Restrooms located .2 miles up the path.
- Firewood available to purchase through the Greenway.
- Bar packages must be ordered through the Greenway; no outside alcohol allowed.
- Caterer and DJ may be client's choice. Certificate of Insurance required.
- Tenting, lightning and other rentals available through Creative Solutions only.
- All other vendors may be client's choice.
- 5-hour access times available Monday-Sunday.
- 10-hour access times available Monday-Sunday.





OAK ROOM AT
FORT
MILL
GOLF



The Oak Room at Fort Mill Golf Club features an open concept event space with floor-to-ceiling windows, a wraparound porch with rocking chairs and panoramic views of the golf course. The space comes equipped with tables and seating for up to 75, a 75" flat screen TV and access to Fort Mill Golf/Greenway catering packages. The Oak Room is an ideal location for intimate events or workshops.

Ideal for receptions, corporate gatherings, celebrations of life, social events, showers and other intimate gatherings.





PRICING

Mon-Thurs, 5 Hours	\$500
Mon-Thurs, 10 Hours	\$800
Fri-Sun	\$1,300
Saturday	\$1,500

CAPACITY

100 Seated

- Venue host on site for duration of your rental.
- Beautiful indoor overlook of golf course.
- The Oak Room cannot accommodate wedding ceremonies. Please visit one of our other venues for this specific event request.
- Access to Golf Club restrooms and locker-room. Areas cannot be blocked off.
- Standard tables and chairs included with venue rental as well as covered auxiliary tables for food and beverage displays.
- Wifi included with rental
- Bar packages must be ordered through Fort Mill Golf Club/Greenway Catering; no outside alcohol allowed.
- Catering must be ordered through Fort Mill Golf Club/Greenway Catering with the exception of desserts.
- Table linens for dining tables are not included.
- Tenting, lighting, linens, and other rentals available through Creative Solutions only.
- Venue is on an active golf course and operations will not shut down for your event.
- All other vendors may be client's choice.
- 5-hour access times available Monday-Thursday.
- 10-hour access times available Monday-Sunday.



THE PAVILION AT SPRINGFIELD GOLF



Tucked into Fort Mill's Springfield neighborhood, the Pavilion at Springfield Golf features ceiling fans, a fire pit and lawn space overlooking Hole #9 on the golf course. Residency in the neighborhood is not required for rental.

Ideal for wedding ceremonies, corporate gatherings, celebrations of life, social events, picnics and other intimate gatherings.





PRICING

5 Hours	\$800
10 Hours	\$1,300

Pricing dependent on number of guests and hours rented. Prices may be higher in peak season (April-June and Sept-Nov).

CAPACITY

Pavilion	125 Seated
	200 Standing
Lawn	200 Seated

- Venue host on site for duration of your rental.
- Beautiful outdoor overlook of golf course.
- The Pavilion cannot accommodate wedding ceremonies. Please visit one of our other venues for this specific event.
- Access to Golf Club restrooms and cart barn restrooms. Areas cannot be blocked off.
- Outdoor folding tables and chairs included with venue rental as well as covered auxiliary tables for food and beverage displays.
- Bar packages must be ordered through Springfield Golf Club/Greenway Catering; no outside alcohol allowed.
- Catering must be ordered through Springfield Golf Club/Greenway Catering with the exception of desserts.
- Table linens for dining tables not included.
- Tenting, lighting, linens, and other rentals available through Creative Solutions only.
- Venue is on an active golf course and operations will not shut down for your event.
- All other vendors may be client's choice.
- 5-hour access times available Monday-Sunday.
- 10-hour access times available Monday-Sunday.



VENUES AT
SPRINGMAID
MOUNTAIN



Just miles from the Blue Ridge Parkway, Springmaid Mountain provides a perfect backdrop your event! Located on the North Toe River in Spruce Pine, NC, this secluded mountain retreat is an approximate two hour drive from the Charlotte metro area and provides ample lodging options and on-site amenities. Special events at Springmaid Mountain offer a peaceful haven for creating memorable occasion for you and your guests.

Ideal for wedding getaways, corporate gatherings, retreats, birthday parties, social events, and other gatherings needing accomodations.



RESORT AMENITIES :

- 16 on-site cabins, including Lodge (sleeps 12) and Bunkhouse (sleeps 32), and campground able to accommodate tents, RVs and small campers.
- Group discounts available.
- On location event coordination and planning provided.
- Wagon rides and horseback riding available for additional charge.
- Space available for pre-event storage and setup.
- Multiple scenic ceremony locations. (site fees vary)
- Horse and carriage option available to bride for additional fee.



PRICING

1- or 2-Day with 50 Guests	\$800
1- or 2-Day with 100 Guests	\$1,000



- Venue host on site for duration of your rental.
- Tables, chairs, and linens to accommodate up to 100 guests available.
- Caterer, bar and DJ may be client's choice. Certificate of Insurance required.
- Two+ restrooms located on site.
- All other vendors may be client's choice.

For more information, please visit www.springmaidmountain.com/about/contact-us/



PREFERRED VENDORS

ACCOMMODATIONS

Aloft Charlotte, Ballantyne
Ballantyne Hotel - 704.248.4000
Cambria - 803.591.9867
Courtyard Marriott, Fort Mill - 803.835.0706
Hampton Inn & Suites, Fort Mill - 803.578.2600
Hyatt House/Rea Farms - 980.339.4900

BAKERS / CAKES / DESSERTS

Celestial Cakery
celestialcakery@gmail.com | 804.229.1194
K&M Sweet Treats
sweettreatskm@gmail.com | 828.381.1156
Skys the Limit Bridal Sweets
STLBridalSweets@gmail.com | 704.787.8404
Publix Gold Hill Road - 803.548.7900
Renaissance Patisserie
renaissancepatisserie@gmail.com | 980.819.8771
Suarez Bakery
hello@suarezbakery.com | 704.525.0145
The Peach Stand
info@peachstand.com | 803.547.7563

CATERING

Anne Springs Close Greenway - 803.547.1009
Best Impressions - 704.333.9779
Carolina BBQ & Catering - 803.371.0397
Plate Perfect - 704.343.0155
QC Catering - 704.305.778
Something Classic - 704.377.4202
Your Farms, Your Table - 980.549.1999

DJ & A/V SERVICES

All the Right Grooves - 704.763.6196
ATG Entertainment - 704.537.9300
Carolina DJ Professionals - 704.990.5622
EastCoast Entertainment (ECE) - 704.339.0100
FireFly Productions AV - 336.978.5596
Split Second Sound - 704.907.9507
Norman Audio Visual - 704.839.6616
Z Brothers Entertainment - 704.618.4000

FLORISTS

April's Floral Expression (silk flowers)
april'sfloral@yahoo.com | 704-572-8398
Buy the Bunch - 803-547-5996
Chelish Moore
chelish@msn.com | 704.782.9883 | 704.701.9103

Lily Greenthumbs (Florists Continued)
flowers@lilygreenthumbs.com | 704.910.2540
The Flower Diva - 704.889.3482
What's Up Buttercup
info@whatsupbuttercupllc.com | 803.417.7149

PLANNING

Creative Solutions Special Events - 704.825.8701
Dotted Weddings & Events
planning@dottedweddings.com | 315.558.0639
Katrina Hutchins Events
katrina@katrinahutchins.com
Party Tables
shay@partytables.com | 704-526-505
Plain with Sprinkles
hello@plainwithsprinkles.com
Southern Savvy Events
info@southernsavvyevents.com | 704.254.5491
Spark by Design
helen@sparkbydesign.events | 704.525.9233
Style Perfect
info@styleperfect.com | 704-975-9941
YH Events
yhweddingandevents@gmail.com | 803.389.0639

PHOTOGRAPHY

Carissa Rogers Photography - 541.880.4982
Emily Chidester - www.emilychidester.com
Indigo Photography & Video - 704.778.5603
J. Pellin Videography
info@jenniferpellin.com | 864.344.2587
Katherine Elena Photography
katie@katherineelenaphotography.com | 704.330.9425
M & P Weddings
mpweddingservices@gmail.com | 631.786.9065
Moving Mountains Photo & Film
info@movingmountainsphotography.com | 704.745.2515
Paper Heart Photography
kate@paperheartphotos.com | 434.851.0633
YAH Photography
kelli@yahphotography.com | 803.400.3982

TRANSPORTATION

24k Rides - 704.568.1200
Connections Transportation - 704.589.7744
Elite Limo - 828.890.2424
Silver Fox Limos - 704.622.9944

FREQUENTLY ASKED QUESTIONS

Can we tour the venue?

Yes. Once a [Venue Request Form](#) has been completed, our sales team will contact you to discuss pricing and availability and to schedule a private tour of your preferred venue.

Can we bring in our own alcohol?

No. All alcohol packages are customizable through the Gateway Canteen. For your convenience, please reach out to us for details on setting up your bar package.

Are tables and chairs included?

No. All tables, chairs, and linens are available through our exclusive rental company Creative Solutions.

Can we choose our own vendors?

You can, with the exceptions of your rental and bar needs. Please note that all caterers must provide a business license and certificate of insurance.

Do you offer planning services?

We do not. We do have many wonderful planners on our Preferred Vendors List. We will provide an on-site Venue Host who is there to assist with venue-related questions.

Is parking included in my venue rental?

Yes, parking is included for all clients and event guests.

What is required to book the venue?

We require a security deposit and signed contract.

When can we access the venue?

Your access time begins at the start of a five (5) or ten (10) hour time frame.







Venues@ASCGreenway.org | 803.547.1009

ASCGreenway.org

   @ASCGreenway